

Dimension: (UNIT:mm)

A	12.5 ± 0.3
B	6.2 ± 0.1
C	3.5 ± 0.1
D	4.55 ± 0.15
E	9.0 ± 0.25
F	5.4 ± 0.15
G	2.0 ± 0.1
H	

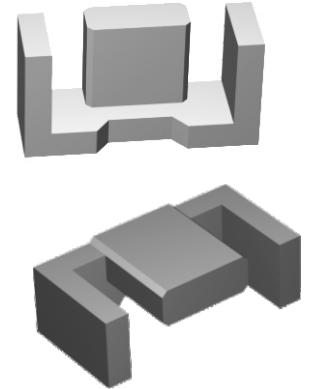
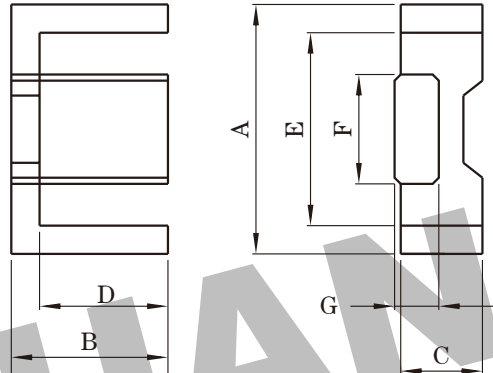

Test conditions

AL: F=1.0KHz U=0.3V N=10Ts

Effective parameter

C1(mm) ⁻¹	Ae(mm ²)	Le(mm)	Ve(mm ³)	Weight(g)
2.5	11.4	28.5	325	≈0.9

Core sets of high permeability grades.
Clamping force for Al measurements, 10+/-5N

Core sets

Clamping force for Al measurements, 15+/-5N

Grade	AL (nH)	μe	AIR GAP μm	Type number
H5K	2800+40/-30%	≈5570	≈0	EFD12-H5K

Grade	AL (nH)	μe	AIR GAP μm	Type number
P3	40 ± 5%	≈ 80	≈ 540	EFD12-P3
	63 ± 8%	≈ 125	≈ 290	EFD12-P3
	100 ± 10%	≈ 200	≈ 160	EFD12-P3
	825 ± 25%	≈ 1610	≈ 0	EFD12-P3
P4	40 ± 5%	≈ 80	≈ 540	EFD12-P4
	63 ± 8%	≈ 125	≈ 290	EFD12-P4
	100 ± 10%	≈ 200	≈ 160	EFD12-P4
	825 ± 25%	≈ 1610	≈ 0	EFD12-P4
HQ2KA	750 ± 25%	≈ 1460	≈ 0	EFD12-HQ2KA
HQ2K	40 ± 5%	≈ 80	≈ 540	EFD12-HQ2K
	63 ± 8%	≈ 125	≈ 290	EFD12-HQ2K
	100 ± 10%	≈ 200	≈ 160	EFD12-HQ2K
	700 ± 25%	≈ 1370	≈ 0	EFD12-HQ2K
P5	550 ± 25%	≈ 1070	≈ 0	EFD12-P5

Properties of core sets under power conditions

Grade	B (mT)at H=250 A/m F=25KHz T=100°C	Core loss (w) at			
		F=100 KHz B̂=100mT T=100°C	f=100 KHz B̂=200mT T=100°C	F=400 KHz B̂=50mT T=100°C	F=500 KHz B̂=50mT T=100°C
P3	≥320	≤0.036	-	-	-
P4	≥320	≤0.029	≤0.2	-	-
HQ2KA	≥340	≤0.022	≤0.15	≤0.06	≤0.12
HQ2K	≥315	≤0.04	-	≤0.065	-
P5	≥300	-	-	≤0.03	≤0.045

Properties of core sets under power conditions (continued)

Grade	B (mT)at H=250 A/m F=25KHz T=100°C	Core loss (w) at			
		F=500 KHz B̂=100mT T=100°C	F=1.0 Mhz B̂=30mT T=100°C	F=1.0MHz B̂=50mT T=100°C	F=3.0MHz B̂=10mT T=100°C
P3	≥320	-	-	-	-
P4	≥320	-	-	-	-
HQ2KA	≥320	-	-	-	-
HQ2K	≥315	-	-	-	-
P5	≥300	≤0.35	-	-	-

Note:

- 1: Document is the property of FUAN Inc & is not allow to be duplicated without authorization
- 2: RoHS compliant.